



FORMULA

42 Racing

B4

SOSTITUZIONI PASTIGLIE

REPLACING THE PADS

REMPLACEMENT PLAQUETTES

ERSETZUNG DER BELÄGE

SUSTITUCION DE PASTILLAS

GENERAL INSTRUCTIONS

Follow strictly the instructions contained to ensure a long service life for the braking system and to prevent common accidents which may occur during maintenance.

Warning: B4 pads should be replaced only by qualified personnel authorized by the manufacturer. Failure to observe these instructions will void the warranty.

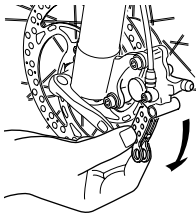
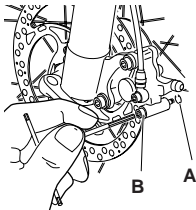

B4

Replacing brake pads

It is not essential to disassemble the wheel and caliper of the bicycle in order to replace the brake pads.

WARNING

When removing the old pads, proceed with caution while using a screwdriver as it may slip and cause injuries. Formula recommends wearing protective gloves to avoid accidents.

Proceed as follows:

- Remove the snap ring **A** with a screwdriver
- With a 4mm Allen wrench loosen the **B** screw that holds the pads in place.
- Take the brake pads between two fingers as shown in the illustration and remove them. To make this easier, turn the wheel round gently.



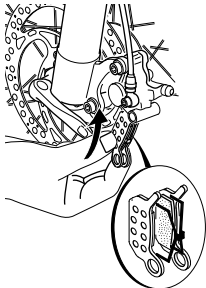

- Remove any trace of mud or dust and with a big tip screwdriver exert a light pressure on the pistons to move them backward thus allowing pads insertion.
- Take the pads and the spring with two fingers (see illustration) and insert them in the specific seat.
- Align the hole of the pads and of the caliper, then insert screw **B** tightening it correctly ($5.75 \text{ Nm} \pm 5\%$).
- Reassemble the safety snap ring **A**.

CAUTION
ISOPROPYL ALCOHOL is recommended to clean the disk brake.
 The use of any other product may be hazardous to the user.

WARNING
 The brake system needs a break in period. Formula suggests to brake at least a hundred times before considering it broken in and fully efficient.

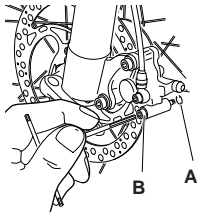

GENERAL INSTRUCTIONS

Follow strictly the instructions contained to ensure a long service life for the braking system and to prevent common accidents which may occur during maintenance.

Warning: 4-Racing pads should be replaced only by qualified personnel authorized by the manufacturer. Failure to observe these instructions will void the warranty.

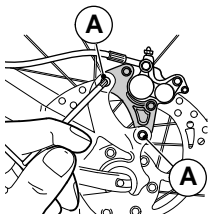
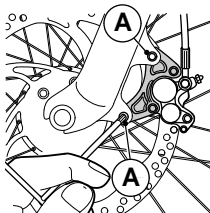

4-Racing

Replacing brake pads

In order to replace front and rear brake pads remove the caliper from its bracket by unscrewing the fastening screws **A** using a suitable wrench.

WARNING

When removing the old pads, proceed with caution while using a screwdriver as it may slip and cause injuries. Formula recommends wearing protective gloves to avoid accidents.



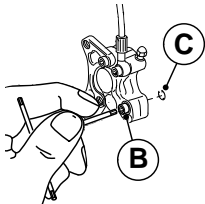

Proceed as follows:

- Remove the snap ring **C** with a screwdriver
- With a 4mm Allen wrench loosen the **B** screw that holds the pads in place.

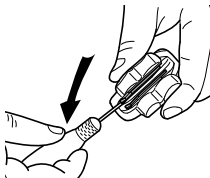

- Insert a small tip screwdriver (see illustration) and apply a light pressure to lift and take out the worn pads

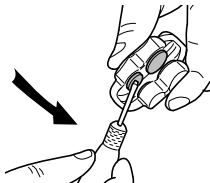

- Remove any trace of mud or dust and with a big tip screwdriver exert a light pressure on the pistons to move them backward thus allowing pads insertion.



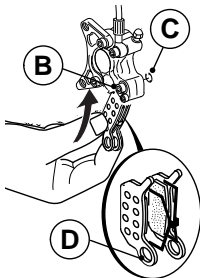

- Take the pads and the spring with two fingers (see illustration) and insert them in the specific seat.
- Align the hole **D** of the pads and of the caliper, then insert screw **B** tightening it correctly ($5.75 \text{ Nm} \pm 5\%$).
- Reassemble the safety snap ring **C**.
- Reassemble the caliper unit on the fork or on the frame following the brake system's guidelines. Practice braking operations as instructed in the operating manual.

CAUTION

ISOPROPYL ALCOHOL is recommended to clean the disk brake.
The use of any other product may be hazardous to the user.

WARNING

The brake system needs a break in period. Formula suggests to brake at least a hundred times before considering it broken in and fully efficient.

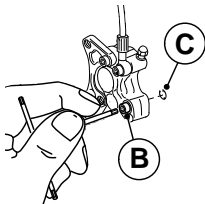

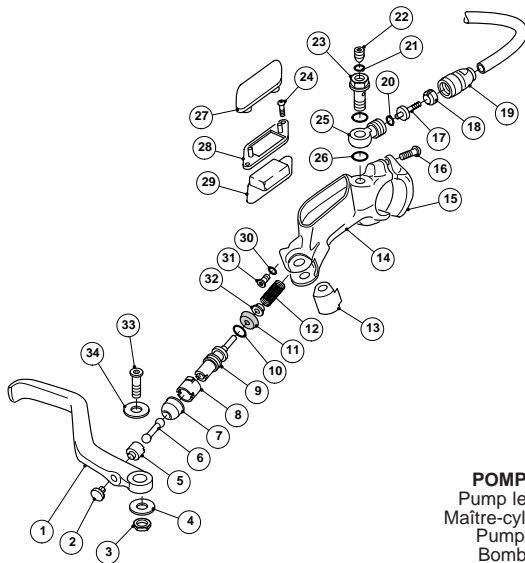

POMPA
 Pump lever
 Maître-cylindre
 Pumpe
 Bomba



PINZA FRENO

Caliper
Etrier
Bremssattel
Pinza

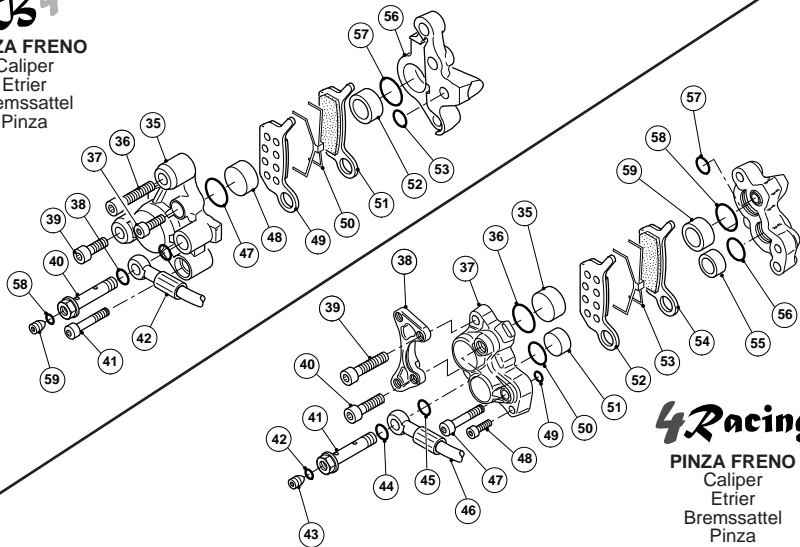

4Racing

PINZA FRENO

Caliper
Etrier
Bremssattel
Pinza

www.formula-brake.com



via Erbosa, 63 - 59100 Prato - Italy
tel. ++39 0574 603609 - fax ++39 0574 611046

E-Mail: formula@formula-brake.it